

## LE5 BODY-WORN CAMERA

The LE5 is an easy to operate wearable video camera designed specifically for law enforcement and security professionals.

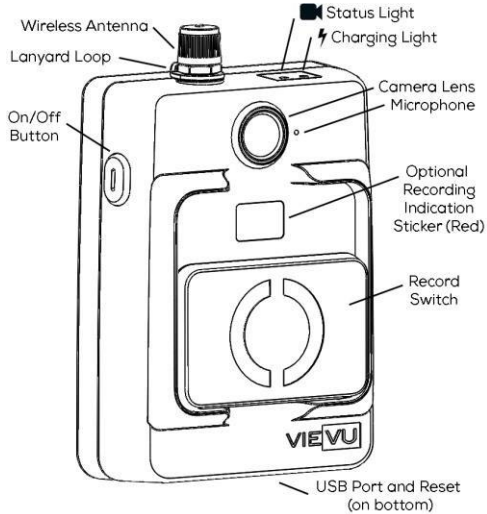

## TECHNICAL SPECIFICATIONS

|                      |                                      |
|----------------------|--------------------------------------|
| Video Resolution     | 1080 (FHD), 720 (HD) or 848x480 (SD) |
| Recording Speed      | 30 Frames Per Second                 |
| Recording Format     | MPEG-4, H.264 Codec, AVI container   |
| Lens Field of View   | 70, 95, 120 degrees selectable       |
| Recording Life       | 12+ hours*                           |
| Storage Capacity     | 64 GB (non-removable)                |
| Video Storage        | 56 hours at SD Resolution*           |
| Weight (no clip)     | 4.9 oz                               |
| Dimensions (no clip) | 2.52" x 3.40" x 1.10"                |
| Input                | DC 5V                                |
| Temperature          | -4°F - 122°F                         |

\* Camera Feature Configuration, Environmental Conditions and Age May Increase or Decrease Specification

## LED LIGHTS

### STATUS LIGHT



- Fast Blink Blue: Camera is turning On.
- Solid Red: Camera is On. Prerecord buffer is Off.
- Slow Blink Red: Camera is On. Prerecord buffer is On.
- Slow Blink Green: Camera is recording video and audio.
- Fast Blink Yellow: Camera is low on battery power or memory is almost full. Camera is recording video and audio.
- Solid Yellow: Camera is not recording. Battery is out of power or memory is full.
- Slow Blink White: Camera is installing firmware. Do not turn the camera Off or disconnect it from power or the camera firmware update may fail and cause the camera to become unresponsive.
- Solid Blue: Camera is connected and in queue to download.
- Slow Blink Blue: Camera is downloading video.

### CHARGING LIGHT



- Solid Red: Battery is charging.
- Solid Green: Battery is fully charged.

If Covert Mode is enabled, LED lights will not illuminate. Vibration will be enabled to indicate when the camera starts and stops recording.

## RECORDING INDICATION STICKER (OPTIONAL)

A red sticker is included that can be placed below the camera lens. This will give others a visual indication when the camera is recording video.

## NEED HELP?

Phone: **888-285-4548**

Email: **support@viewu.com**

Rev2 (October 30, 2018)

VIEVU

645 Elliott Ave W Ste 370 Seattle WA 98119

VIEVU®

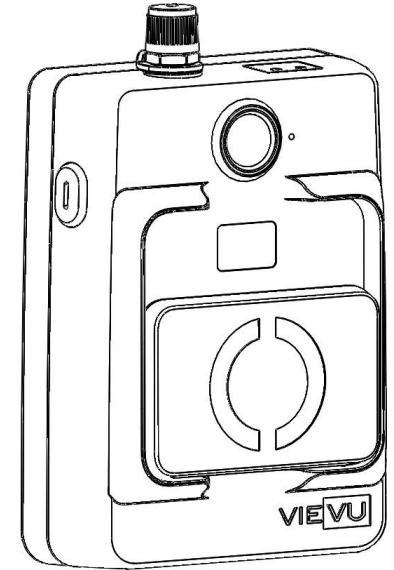

LE5™

INSTRUCTIONS

# FIRST TIME SETUP

## 1. SELECT YOUR SOFTWARE

Go to [www.viewu.com/LE5setup](http://www.viewu.com/LE5setup) and complete the sign-up process. After sign-up is complete, you will receive a welcome email with additional information.

## 2. INSTALL SOFTWARE ON COMPUTER

The welcome email will contain a link to the software to install. Contact VIEVU support at 888-285-4548 if you need assistance.

## 3. ASSIGN THE CAMERA

**NOTE:** All cameras must be assigned to a user before recording video. Failure to assign the camera will prevent downloading videos.

Using the supplied cable, connect the large USB connector to the computer. Connect the small connector to the bottom of the camera. Click the 'Assign Camera' button in the software. For complete steps, consult the User Guides found in the welcome email.

# USING THE CAMERA

## CHARGING THE BATTERY

Before use, the camera must be fully charged. An optional wall charger is available for purchase at [www.viewu.com/accessories](http://www.viewu.com/accessories).

1. Using the supplied cable, connect the large USB connector to the computer. Connect the small connector to the bottom of the camera.
2. The charging light is solid red while the battery is charging. The charging light is solid green when the battery is fully charged.

## MOUNTING OPTIONS

The camera is fitted with a ClipLock mounting adapter and a spring clip. Additional mounting options are available at [www.viewu.com/accessories](http://www.viewu.com/accessories).

## USING CLIPLOCK™

ClipLock is an interchangeable clip attachment system. Visit [www.viewu.com/cliplock](http://www.viewu.com/cliplock) for a video demonstration.

To use, (1) align clip with camera. Rectangle cutout is at the top. (2) Rotate clip 90° counter-clockwise. (3) Push clip up to lock.

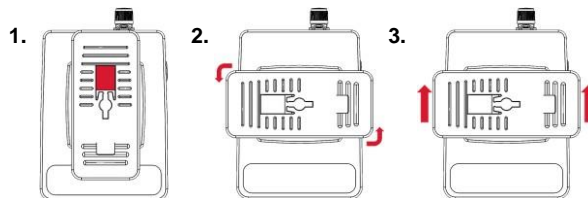

## WEARING THE CAMERA

The camera must be worn with the LED lights facing up. The ideal position to attach the camera is level with the sternum but will vary depending on the user.



## RECORDING VIDEO

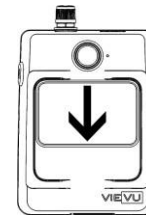

### START RECORDING

Slide the record switch down.  
The camera status light will blink green.



### STOP RECORDING

Slide the record switch up.

## CONNECTING TO A SMARTPHONE

The LE5 is compatible with most major smartphones. Consult the User Guides found at [www.viewu.com/support](http://www.viewu.com/support) for complete steps for your device.

## DOWNLOADING VIDEO

### CABLE DOWNLOAD

1. Using the supplied cable, connect the large USB connector to the computer. Connect the small connector to the bottom of the camera.
2. Login to the VIEVU software to download. Consult the User Guides found at [www.viewu.com/support](http://www.viewu.com/support) for complete steps.

### DOCKING STATION DOWNLOAD

Insert the camera into an available port on the docking station. The status light will turn blue when the camera is in queue to download. The light will change to blinking blue when video files are being downloaded. The light will turn off when the download process is complete.

## WARNINGS

This document presents important safety warnings, instructions, and information intended to minimize hazards associated with the use of VIEVU, LLC's ("VIEVU") VIEVU camera systems. These instructions and warnings are for your protection as well as the safety of others.

**Read the entire document before using any VIEVU system.**

Failure to follow these safety instructions could result in fire, electric shock, damage, system malfunctions, death, or personal injury.

**Potentially explosive environments.** Electric sparks in a potentially explosive area could cause an explosion or fire, resulting in serious injury or even death. Areas with a potentially explosive atmosphere are often, but not always, marked clearly. Potential areas may include: fueling areas (such as gas stations); below deck on boats; fuel or chemical transfer or storage facilities; vehicles using liquefied petroleum gas (such as propane or butane); areas where the air contains chemicals or particles (such as grain, dust, or metal powders); and any other area where you would normally be advised to turn off your vehicle engine. LE4 Body-Worn Camera, LE5 Body-Worn Camera, and LE5 LITE Body-Worn cameras contain wireless transmission technology that transfers radio frequencies over the air as a form of energy transfer. Wireless transmission has been deemed a risk factor in igniting an explosive environment. In situations where the VIEVU camera operator needs to enter a potentially explosive environment, VIEVU recommends that the user err on the side of caution and power off the camera before entering the explosive environment. A VIEVU camera should be treated the same as a cellular telephone would be treated in this situation.

## VIEVU SYSTEM USE

**Use only VIEVU-approved components, batteries, and accessories.**

Only VIEVU approved components, batteries, and accessories are to be used with the systems. Use of anything other than VIEVU-approved components,

batteries, or accessories will void the warranty, may cause malfunction, and may put the user or other person at risk of injury.

## THE BATTERY

- 1. Do not replace the battery in the LE5 Body-Worn Camera.** The battery in the LE5 Body-Worn Camera is not designed to be replaced. DO NOT attempt to replace the battery.
- 2. Charging the battery.** The VIEVU system batteries must be charged prior to use. Only use the approved VIEVU chargers and connectors. Be aware that a battery can fail to function, fail to charge, fail to maintain a charge, or deteriorate over time.
- 3. Avoid extreme temperatures.** Do not expose the battery to excessive heat, cold, water, other liquids, or corrosive substances. Do not use or leave the batteries for on-officer cameras near a heat source or at a very high temperature (for example, fire, heater, in strong direct sunlight, or in a vehicle in extremely hot weather). Otherwise, the battery may overheat, cause a fire, or its performance will be degenerated, and its service life will be shortened.
- 4. Avoid static electricity.** Keep the battery away from sources of static electricity. Static electricity can cause damage to the battery, which could result in serious injury.
- 5. Recharging.** When recharging VIEVU equipment, use a VIEVU-approved power source specifically for that purpose. Do not reverse the positive (+) and negative (-) terminals. Do not connect the battery to

an electrical outlet without using a VIEVU-approved adapter.

- 6. Handling.** Ensure proper connections between the VIEVU equipment when charging a VIEVU component. To avoid risk of fire, burns, or damage to your battery pack, do not: allow a metal object to touch the battery contacts; strike or throw the battery; directly solder the battery or pierce the battery with a nail or other sharp object; disassemble, short circuit, or heat batteries; or put batteries in a fire. Doing so may cause battery explosion, battery leakage, system damage, injury, or fire.
- 7. Abnormal appearance.** If the battery gives off an odor, generates heat, becomes discolored or deformed, or in any way appears abnormal during use, recharging or storage, immediately place the VIEVU component with the battery in a contained vessel such as a metal box.
- 8. Avoid battery acid contact with skin or eyes.** In case the battery acid gets into the eyes due to the leakage of battery, do not rub the eyes. Rinse the eyes with clean running water, and immediately seek medical attention. Battery acid's contact with the eyes or skin could cause serious injury, including a loss of eyesight.
- 9. Disposal.** Dispose of any battery properly; contact your local waste disposal provider regarding local restrictions on the disposal or recycling of batteries. Do not dispose of the battery in fire or heat; the battery may explode if placed in the fire. Do not dispose of the battery in water.